

Conditional Use Permit Application Narrative

Small Church Day School to Operate in Church Owned Facility

I. Requestor and Proposed Location

Lighthouse Baptist Church
118 Neal Street
Pleasanton, CA 94566
(925) 846-7220

RECEIVED

11/18/2021

P21-0715

CITY OF PLEASANTON
PLANNING DIVISION

EXHIBIT B

II. Summary and History

- A. Lighthouse Baptist Church requests conditional use permit to operate their small christian day school on church property at 118 Neal Street.
- B. Lighthouse Baptist School has been in continuous operations since 1992 at various locations all in the city of Pleasanton.
- C. Lighthouse Baptist School has been operating for the past 3 years at the facility owned by Ridgeview Hope Church at 5901 Coronado in Pleasanton.
- D. Due to pandemic downturn in spaces, we are have lost our lease at Ridgeview Hope and are in desperate need of a location.

III. Building Utilization for School

- A. Hours of operation
 1. Monday through Friday 7:30-3:30. Classes currently begin at 8:00 AM and dismiss at 3:00 PM
 2. The school is on a 10-month school cycle, generally beginning in August and ending in June.

IV. Instruction Processes and Curriculum

- A. Lighthouse Baptist School utilizes a hybrid of primarily video and supplemented by live teacher led instruction. The ABKA School curriculum is used.
- B. ABEKA in a worldwide leader in Christian education.

V. Class Structure

A. Current plans are to conduct classes in multiple groups divided by age and grade groupings as appropriate and as necessary. Since classroom instruction is nearly entirely video based and personal headphones are used for the students to listen, multiple grades and classes are conducted simultaneously in the same room very effectively.

B. Preset enrollment breakdown:

1. K5 = 1
2. 3rd = 1
3. 5th = 2
4. 6th = 2
5. 7th = 3
6. 11th = 1

C. We are proposing a cap of 25 total student enrollment. Possible breakdown at maximum capacity is seen below.

1. K5 = 3
2. 3rd = 3
3. 5th = 5
4. 6th = 5
5. 7th = 7
6. 11th = 2

VI. School Schedule

A. General plan

1. 8:00 AM – 8:10 AM = opening assembly and attendance taken

2. 8:10 AM – 10:00 AM = classroom instruction
3. 10:00 AM – 10:20 AM = break
4. 10:20 AM – 12:00 PM = classroom instruction
5. 12:00 PM – 12:45 PM = lunch and break
6. 12:45 PM – 3PM = classroom instruction

B. Special activities

1. The last hour of the day varies throughout the week and year.
 - a) Multiple times a week physical education during last hour
 - b) Music, art, and competition preparations are also integrated and alternated through out the week and year.

VII. Support and auxiliary Operations

- A. Lunch – can be taken at student desk or in the lunch-open area as designated on drawings
- B. Recess and Physical Education – various methods used
 1. In common room
 2. On church grounds
 3. On occasion, students may be taken by bus to public areas for tennis, volleyball, soccer practice, etc.

VIII. Student Drop Off and Pick Up

- A. Drop off
 1. Parents will drop off students between 7:30 to 8:00 AM at already city designated and marked loading parking spots in front of building on Neal Street or at designated spots on along side the church on Neal Street.

2. Students will be received by school staff and directed or escorted into the building.

B. Pick up and Dismissal

1. Students will be escorted to their parents in reverse as pickup procedure.

IX. Parking

A. The only persons allowed to park at then school will be the 2-3 teachers and principal.

B. Students will not be allowed to park vehicles at the school.

X. Building Modification

A. By using moveable room dividers and classrooms already in place, we do need any building modifications.

B. No exterior additions or modifications are proposed for this Conditional Use Permit.

C. No interior structural additions or changes are proposed for this Conditional Use Permit.

XI. Miscellaneous information

A. On a typical day, three teachers maximum and one administrator will be present.

B. School hours do not coincide with church service times.

C. California School Affidavit shows school location at 5901 Coronado and the mailing address as 118 Neal Street where our office is located.

D. Lighthouse Baptist School is a private religious school and thus required to comply with all of the state rules for structure and operations that pertain to public state operated schools.

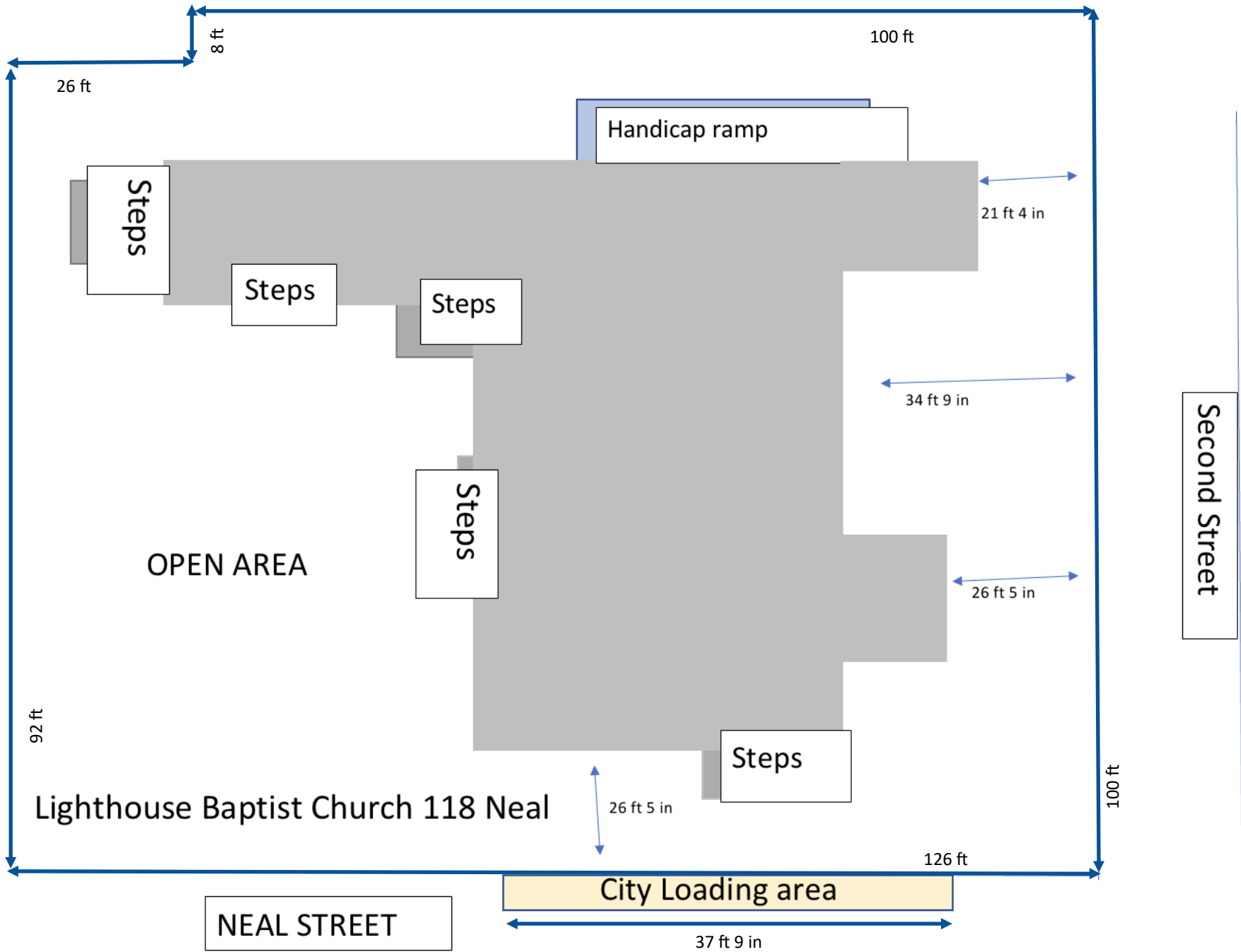

Lighthouse Baptist Church 118 Neal

NEAL STREET

Second Street

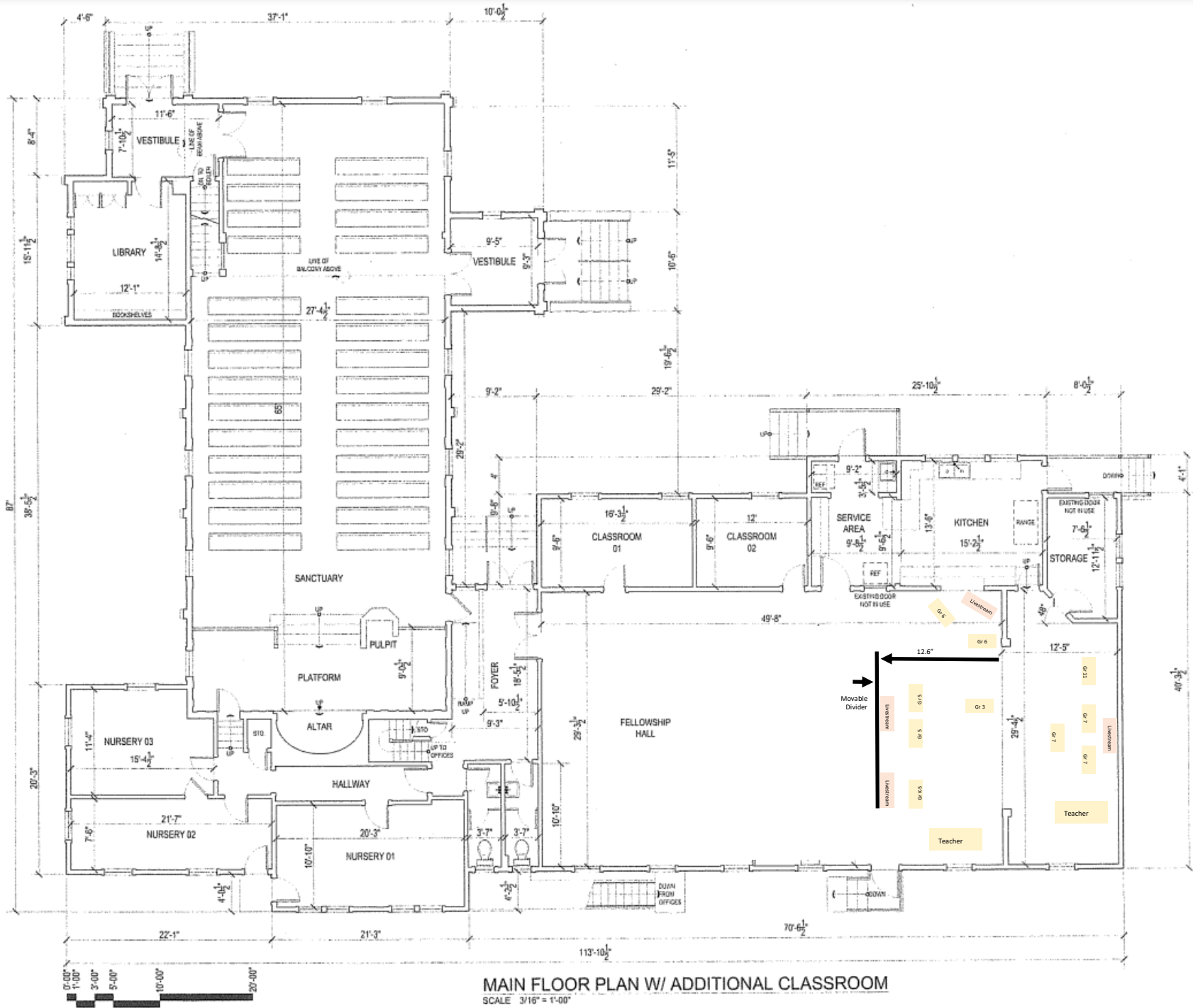

MAIN FLOOR PLAN W/ ADDITIONAL CLASSROOM
 SCALE 3/16" = 1'-00"

Parking Space Use Agreement Between Rock Bible Church and Lighthouse Baptist Church and School

This agreement stipulates that Rock Bible Church agrees to allow Lighthouse Baptist Church and School access to 8 parking spaces at the Rock Bible Church lot at 4100 First street for the purpose of staff and student parking of Lighthouse Baptist School.

Use of school parking will be during all regular school days and hours during the school year.

- This would typically be Monday through Friday, 7:15 AM to 4:00 PM.
- School is normally in session between Mid August and Mid June each year.

Presently there are no regularly scheduled activities requiring more that three parking spots during the days and times described above at Rock Bible Church facilities. There are 80 current parking spaces at the Rock Bible Church lot.

This agreement begins on November 1, 2021 and is indefinite in its duration. It may be canceled by either party with a 30 day notice or adjusted by the agreement of the two parities.

Agreed to on 11-10-2021

Approvals:

Rock Bible Church

4100 First Street, Pleasanton, Ca

Printed name SCOTT BERGLIN / Title LEAD PASTOR

Signature [Handwritten Signature]

Lighthouse Baptist Church

118 Neal Street, Pleasanton, Ca

Printed name Bill Bryson / Title Pastor

Signature [Handwritten Signature]